

Case study

King's College Hospital

A ground-breaking Cell Therapy Unit, the first of its kind in the UK

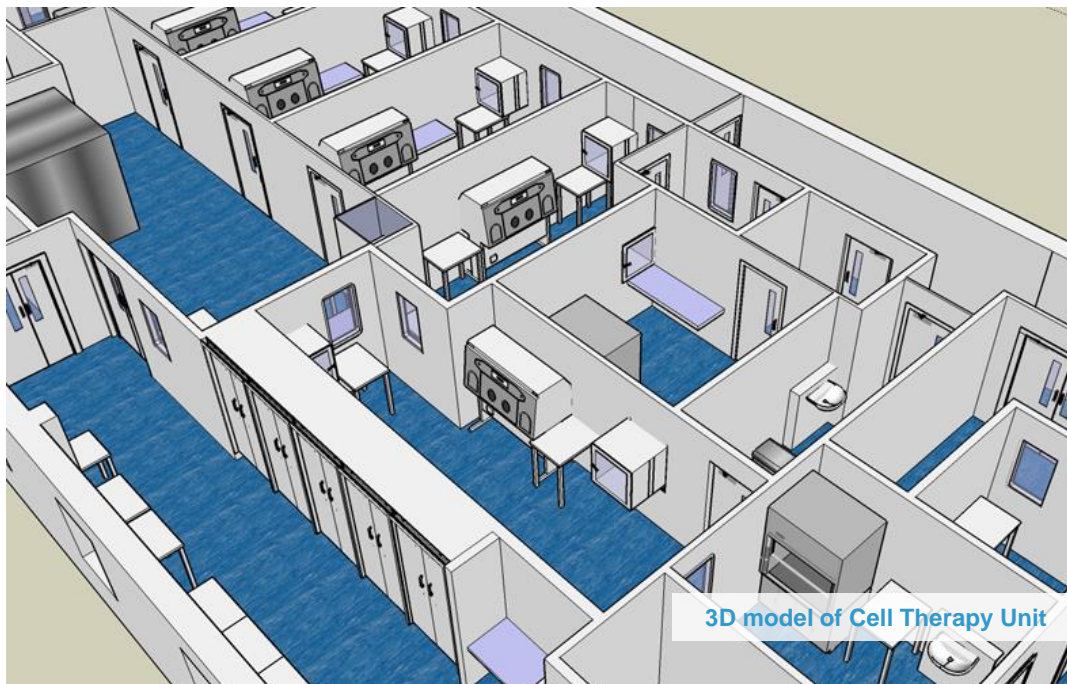

The details

Our role:

Design and Build
Specialist Contractors

Scope:

M&E and Multidiscipline
Construction

Facility type:

Cell Therapy Unit

Floor area:

345m²

Contract value:

£1.6m circa

Programme:

8 months

Enbloc were chosen to design and build a new Cell Therapy Unit on the second floor of King's College Hospital, London due to our past experience in large scale cleanroom projects. The Cell Therapy Unit is a ground breaking facility which is understood to be the first of its kind in the UK. The facility pioneers new Cell Therapies for people living with Diabetes, Leukemia and Liver Failure.

The suite consists of 26 rooms including Grade B, C & D cleanrooms, support, packing and waste treatment areas. The suite has been designed to maintain effective biological and operational segregation by using fully welded vinyl gas tight construction, time delayed access control and dedicated change areas.

A complex HVAC control system involving multiple dedicated extract fans, multiple independent gas tight HVAC zones, dynamic air volume control and an integrated HPV (Hydrogen Peroxide Vapour) gassing systems was installed to allow room sterilization to be carried out whilst adjacent rooms continue to operate.

There are 6 no. Microbiological Safety Cabinets and 6 no. Isolators. The Isolators and Grade B rooms have continuous particle monitoring and all rooms have temperature and pressure monitoring via a CFR21 Part II compliant electronic monitoring system.

See overleaf for project photos...

Case study

King's College Hospital



For more information on the clean facilities that Enbloc can offer please visit our website www.enbloc-cleanrooms.com or contact our head office at:

Enbloc Ltd
Unit 2, Pale Lane
Hook
Hampshire
RG27 8DH

+44 (0)1252 626229

sales@enbloc-cleanrooms.com